

The logo features a stylized, multi-colored shape resembling a DNA helix or a protein structure, composed of red, orange, yellow, and purple segments.

HyPars™

INSTRUCTIONAL MANUAL

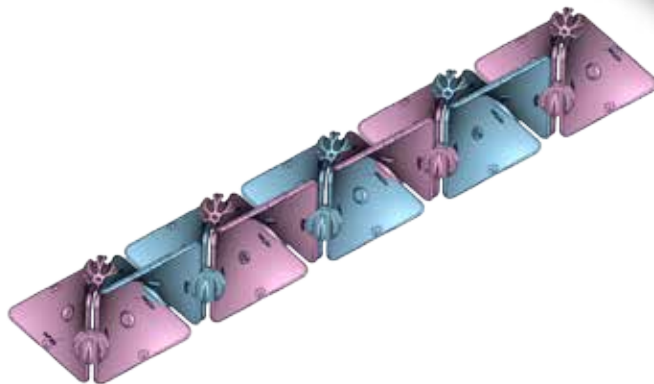

HyPar Cell Left Triangular Bar

-  x8 Violet
-  x8 Violet
-  x6 Aqua
-  x6 Aqua



Warning: Choking Hazard. This kit contains small objects unsuitable for smaller children. US Patent 8,869,464, Second US Patent Pending

1



2

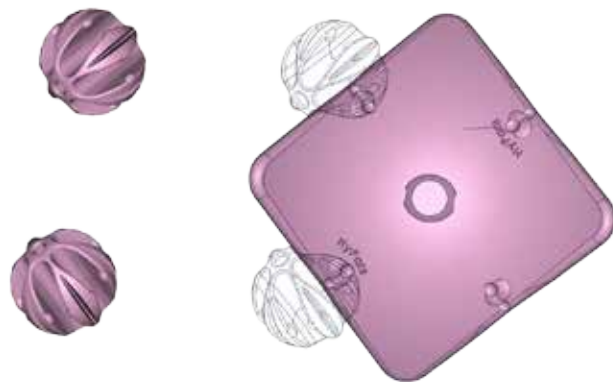

3



4



5

x4 Violet

x3 Aqua



6

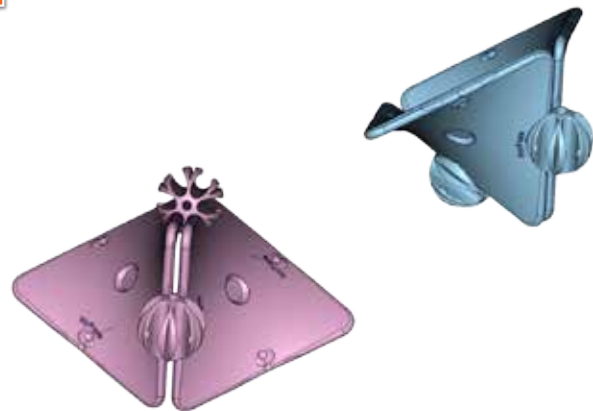

7

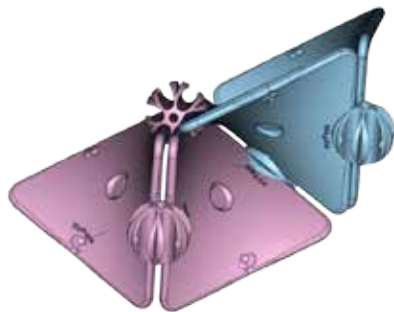

8



9

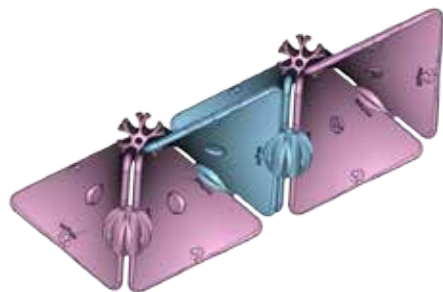

10

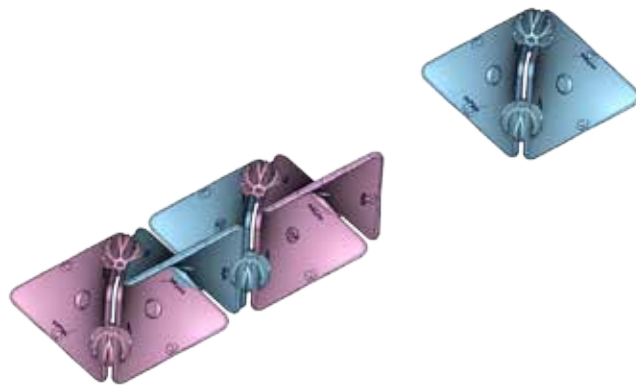

11

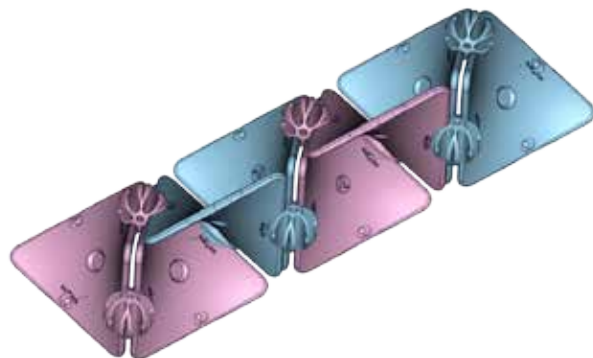

12



13



14

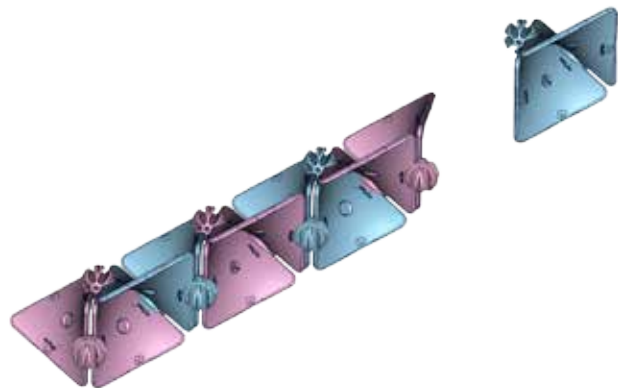

15

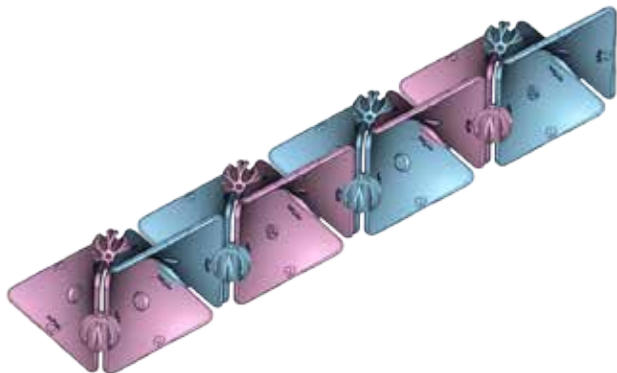

16

