

## Start Here!!

Hello and welcome to HyPars! This primer will introduce you to HyPars, connectors, and some of the basics of attaching them to each other.

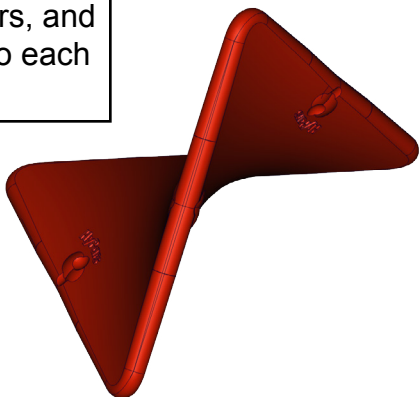

This is a HyPar, short for Hyperbolic Paraboloid. This shape forms the structure of all of the HyPar sculptures! The HyPar lettering is printed on two edges of the HyPar, this should help you orient yourself when connecting HyPars together!

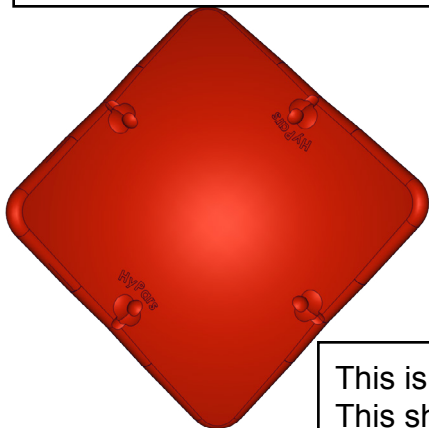
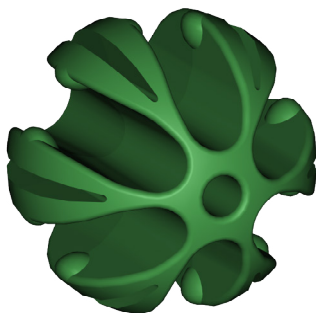
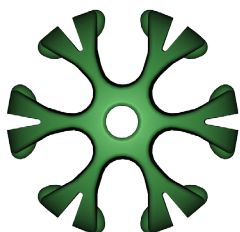

This is a connector. The connectors are used to attach HyPars together in variety of ways. The connector has six slots for attaching HyPars. Counting open slots is the easiest way to tell where you should attach your next HyPar. The connectors also have small slits in between the openings. These slits make it easier to attach and detach HyPars.

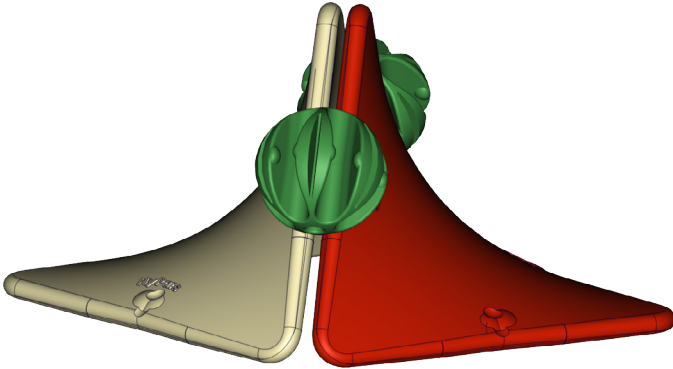

Here are several images of the HyPar Cell. This is one of the most basic building blocks of larger HyPar structures and is a great way to see how HyPars connect and how to use the lettering to make sure you are attaching the HyPars in the proper way.

